

# S&W Supply, LLC

5308 Timberline Trail  
Rapid City SD 57702-1804  
(605) 341-4412

whiz@swsupply.com  
Website: www.swsupply.com



IF YOU DON'T SEE IT, I MAY STILL HAVE IT OR CAN GET IT- MOST TM PARTS ALSO AVAILABLE

Jim White, owner - ATA NRA SDSTA Life Member

SUGGESTED RETAIL PRICE LIST APPLICABLE FORM ..... April 2025

## 12GA REMOVABLE TRIGGER GROUP MODELS

*NOTE: Italy normally raises prices annually in January*

Prices subject to change without prior notice, inquire at the time of order.

RETURNS MAY BE ASSESSED A 20% RESTOCKING FEE

Check my website for parts, prices, schematics and repair instructions



Part #	Description	Price \$	Part #	Description	Price \$	Part #	Description	Price \$
4103	→ Top Lever	481.00	4163	→ Bridle	51.00	4331	→ Lock pin for latch plate lever	11.00
4104	→ Action Block & "hump back" for MT	213.00	4164	→ Cocking foot	65.00	4352	→ Stock Bolt Ass'y Stainless Complete	38.00
4105	→ Safety-●	144.00	4165	→ Right hammer flat spring	66.00	4353	→ Lock washer	11.00
4106	→ Link trigger release	70.00	4166	→ Left hammer flat spring	66.00	4354	→ Plain Washer	11.00
4107	→ Lock trigger plate	59.00	4167	→ Connector Spring	11.00	4355	→ Retainer Guide	18.00
4108	→ Top Lever Release Pin	19.00	4169	→ Sear Spring	11.00	4356	→ Recoil Pad, Genuine Perazzi (S, M, L)	66.00
4109	→ Right ejector trip rod	59.00	4170	→ Connector plunger	11.00	4358	→ Forearm lock screw	14.00
4110	→ Left ejector trip rod	50.00	4171	→ Connector pin	14.00	4359	→ Forearm lock bolt	32.00
4111	→ Locking piece top lever	84.00	4172	→ Connector post pin	14.00	4403	→ Adjustable trigger upper part	159.00
4112	→ Cocking bar	169.00	4173	→ Pivot trip-coil spring removal trigger group	14.00	4404	→ Adjustable trigger lower part	159.00
4113	→ Top firing pin (28/410 ga \$4 higher)	80.00	4174	→ Bridle pin	14.00	4405	→ Adjustable trigger tab	129.00
4114	→ Bottom firing pin (28/410 ga \$4 higher)	80.00	4175	→ Sear retainer pin	14.00	4407	→ Trigger guard for adjustable trigger-●	159.00
4115	→ Pivot-●	36.00	4176	→ Trigger guard pin	14.00	4408	→ Sear trip pin	44.00
4116	→ Safety Spring	36.00	4177	→ Sear retainer sleeve	14.00	4409	→ Trigger Return Spring Plunger	14.00
4117	→ Cocking bar spring/Top Lever Spring	10.00	4178	→ Sear plunger	14.00	4411	→ Trigger Return Spring	11.00
4118	→ Firing pin return Spring -	10.00	4203	→ Right ejector, fitting REQUIRED	259.00	4412	→ Selector pin spring (optional)	14.00
4119	→ Trigger Plate Lock Pin Spring	12.00	4204	→ Left ejector, fitting REQUIRED	259.00	4414	→ Adjustable trigger tab pin	14.00
4121	→ Top Lever Return Spring	14.00	4205	→ Ejector spring plunger	14.00	4415	→ Adjustable trigger tab pin spring	11.00
4122	→ Trigger Plate Lock Cap	18.00	4206	→ Ejector spring	11.00	4419	→ Trigger for external selector-●	169.00
4123	→ Cocking bar check screw	10.00	4207	→ Ejector lock	24.00	4420	→ External selector tab-●	136.00
4124	→ Safety spring screw	11.00	4208	→ Ejector Retainer Pin	11.00	4421	→ Connector for external selector tab	97.00
4126	→ Safety button pin	11.00	4212	→ Front ivory sight – Genuine Perazzi	25.00	4422	→ Pin for external selector tab-●	14.00
4127	→ Link pin	11.00	4212MB	→ Mid-Bead Threaded	25.00	4456	→ Adjustable trigger upper part-●	86.00
4128	→ Lock Pin, Top Lever & Firing Pins	14.00	4306	→ Forearm cocking cam lock screw	21.00	4458	→ Release for external selector-●	100.00
4129	→ Plunger trip (130 spring: \$10.00)	11.00	4307	→ Cocking bar cam	54.00	4471	→ Connector pin for external selector	17.00
4131	→ Ejector Stop Spring Guide	6.00	4308	→ Right ejector sear	51.00	419U	→ Setback Trigger for Selectable Trigger●	390.00
4132	→ Top lever release trip	25.00	4309	→ Ejector sear spring	11.00	3190	→ Full Trigger/Firing Pin Parts Kit w/ Case	300.00
4133	→ Top lever lock trip	25.00	4310	→ Forearm Screw (Type III) – LARGE	19.00	3196	→ Genuine Perazzi Stock Tool – new style	60.00
4134	→ Top lever lock pin return spring	10.00	4313	→ Ejector sear plunger	11.00	6161	→ MT6 Right Hammer for coil springs	213.00
4135	→ Top lever stop plate release pin	25.00	4314	→ Ejector sear pin	11.00	6162	→ MT Left Hammer for coil springs	213.00
4136	→ Top lever stop plate	51.00	4315	→ Forearm Screw (Type III) – SMALL	15.00	6166	→ Right / Left Hammer coil spring	11.00
4137	→ Top lever stop plate rel spg plunger	11.00	4316	→ Ejector trip	65.00	6172	→ Sear trip pivot pin	11.00
4145	→ Under safety	10.00	4317	→ Left ejector sear	51.00	6193	→ Plunger for coil springs	24.00
4155	→ Trigger guard	159.00	4121	→ Forearm Tension Bushing	14.00	Trigger	→ New Pull/Pull Perazzi Trigger	2,040.00
4156	→ Trigger blade (old or new styles)	198.00	4322	→ Catch bolt	44.00	HST	→ Hammer Spring Tool	46.00
4156SB	→ Trigger Blade, Set-Back Gold/Nickle	393.00	4323	→ Cocking bar lock screw	14.00	P Lube	→ Perazzi Special Anti-Gall Lube	21.00
4157	→ Right or Left Release (specify)	97.00	4324	→ Catch Bolt spring	25.00	8195	→ Perazzi HARD ABS Trigger Case-●	79.00
4158	→ Connector	112.00	4326	→ Latch plate	161.00	44088	→ Coil Spring Tool	140.00
4159	→ Right sear	136.00	4327	→ Latch plate lever	75.00	TD	→ Thumb Drive – Comp. Perazzi Repair Inst.	49.00
4160	→ Left sear	136.00	4328	→ Lock screw for latch plate lever spring	11.00	Spacer Kit	→ Spacer Kit for Adjustable Combs	59.00
4161	→ Right hammer for flat springs	213.00	4329	→ Latch plate pin	11.00	Snap Cap	→ Genuine Perazzi Snap Caps – each	29.00
4162	→ Left hammer for flat springs	213.00	4330	→ Return spring latch plate lever	30.00	●	→ Special Order, can take extra week(s)	Questions, call

I specialize in shipping Perazzi parts all over the world. Canadian shipping via USPS is normally about the same as for the lower 48 states. All packages are shipped insured with deliver tracking through USPS. If you provide an email address, you will receive tracking information. I ship extremely fast. If you order on Saturday, I can usually have it in your hands on Monday. I do not ship using customer's shipping accounts, sorry. Being a shooter myself, I realize that time is of the essence. Check my website (listed above) for current pricing - Perazzi prices fluctuate often. I have been servicing Perazzi shotguns and triggers and Ponsness/Warren reloaders for nearly 40 years. All packages shipped insured w/ delivery confirmation. I believe in EXTREMELY FAST SERVICE. If I have it, it ships within 24 hours. Being a shooter myself I realize that time is of the essence. Check my website (listed above) for current pricing - but be aware that Perazzi prices fluctuate. I have been a AA-27 yarder for 40 years. New customer checks may require clearing prior to shipping. **EVEN IF NOT LISTED, I PROBABLY HAVE THE PARTS IN STOCK. IF YOU NEED IT I'LL GET IT FOR YOU!** I am usually in my shop 7 days a week – call at odd hours and I just might answer.

## DETAILS OF 12GA MODELS WITH REMOVABLE TRIGGER GROUPS

Compliments from: Jim "Whiz" White

S&W Supply, LLC

5308 Timberline Trail - Rapid City SD 57702-1804

Voice/AM/FAX: (605) 341-4412 - Email: whiz@swwsupply.com

Website: www.swwsupply.com - New Website: www.shotgun-sports.com



524/06 CATCH 11X11 mm



524/05 CATCH 7X7 mm



525/01 SPRING



526 PIN



527 CIRCLIP

COMPONENTS OF  
ADJUSTABLE RIB

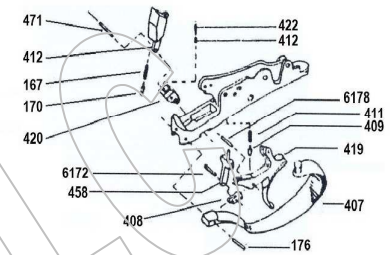
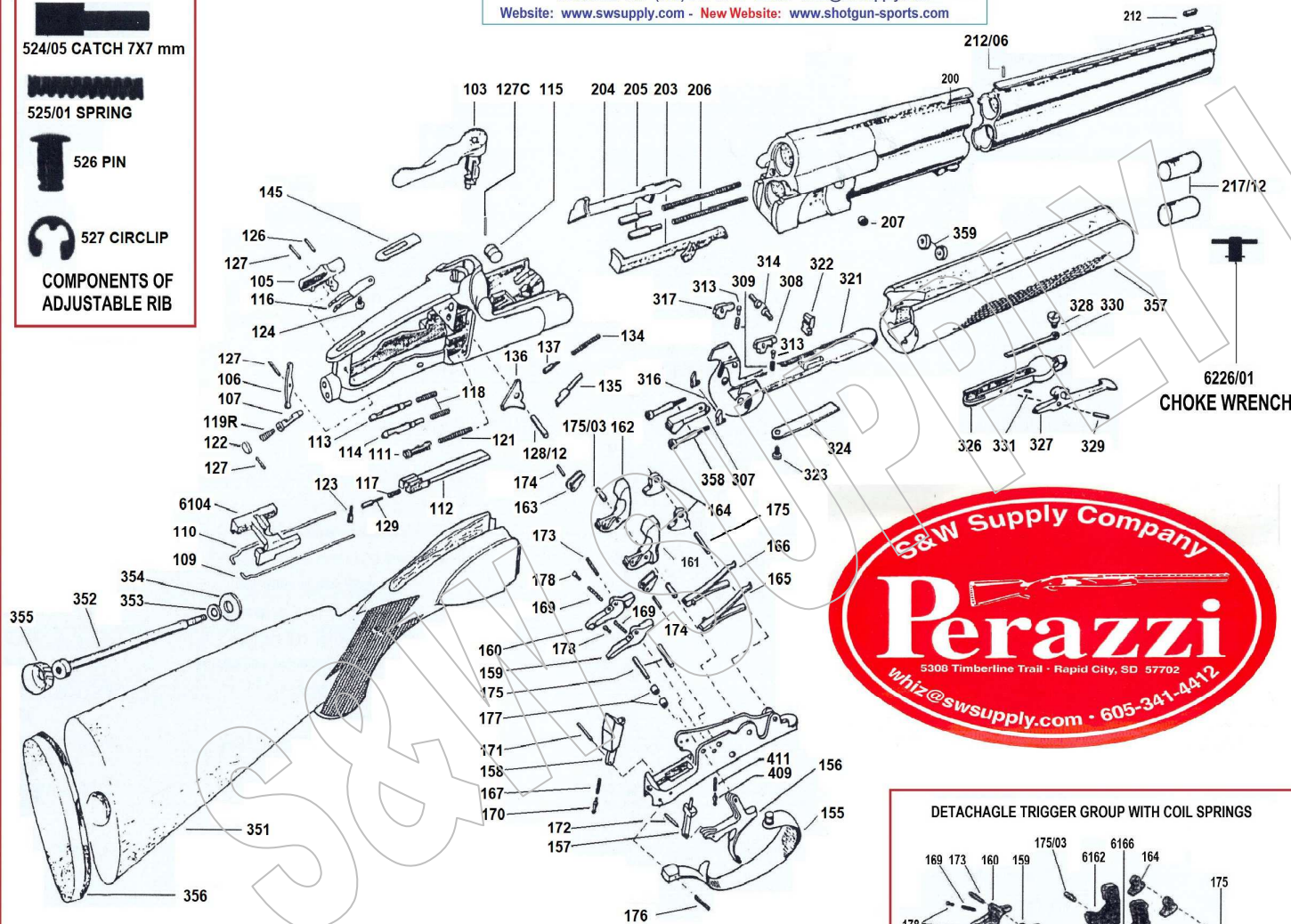

SELECTIVE TRIGGER GROUP

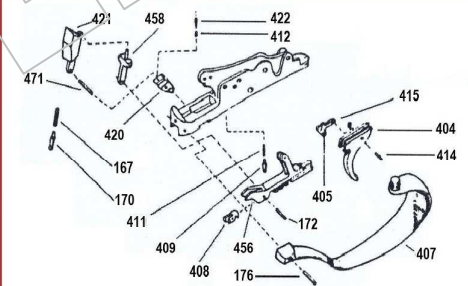

ADJUSTABLE AND SELECTIVE TRIGGER GROUP

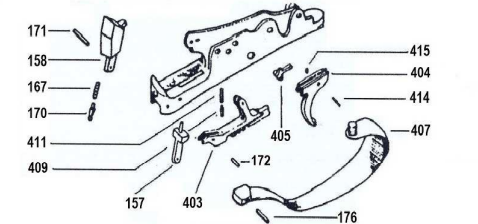

ADJUSTABLE TRIGGER GROUP

### DETACHABLE TRIGGER GROUP WITH COIL SPRINGS

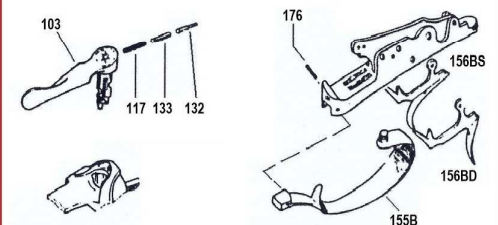
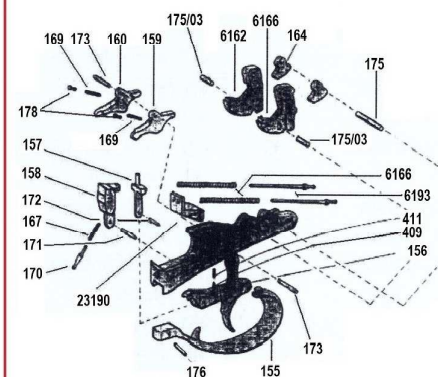

OLD STYLE TOP  
LEVER ASSEMBLY

DOUBLE TRIGGER

I normally carry the entire parts for all Perazzi MX and TM guns. If I do not have it in stock I am able to get these parts from Perazzi on a preferential basis.

Call if you are unsure of what exact part you may need. I have been in the Perazzi business, a well-traveled competitive ATA 27 yarders for 40 years.

